

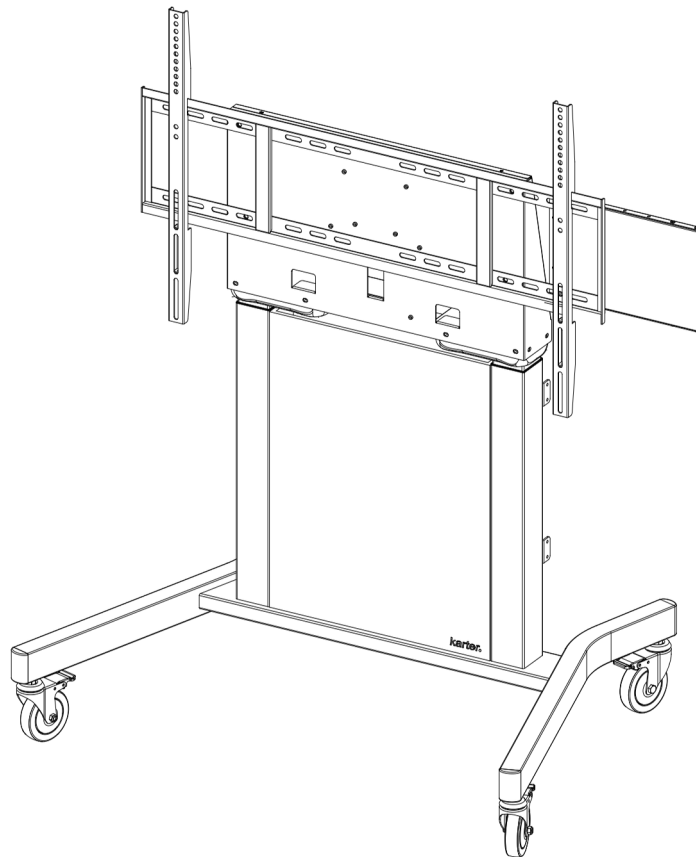

Assembly and Installation Guide



Karter Combi Motorised Mobile Stand **SKU:KMOBCOM**

For using this product properly and safely, please follow the Installation and Operation Manual. It is suggested that this Motorised Stand is suitable for up to 98" inch IFP. Use with other equipment may result in instability causing injury. This stand can carry a maximum weight of 100KG.

karter.com.au

Safety information

Important safety information for both installer and user

Installer:

Before starting the installation, read the safety instructions and this product manual carefully.

Failure to read, thoroughly understand, and follow all instructions can result in serious personal injury and damage to equipment!

User:

Please carefully read the below safety information and user manual (if included) before using the product to ensure a failure-free working unit and avoid accidents.

Electrical Safety Connect the unit to a properly grounded outlet only. Make sure the unit can be immediately separated from the power outlet. Only use the unit in dry rooms, protect it from water and other liquids. Clean the unit with dry cloth only. Do not dismantle lift unit. **RISK OF ELECTRIC SHOCK.** There are no serviceable parts inside. In case of dysfunction, unplug the unit from power outlet and contact an authorised technical service person. Do not overuse the cable(s) or damage it in any other ways. Replace damaged cable(s) immediately with new identical cable(s). Disconnect power cable from power outlet before moving the product. The unit does not have dripping or splashing protection. Do not place any liquid objects on or spray the unit. To reduce the risk of electric shock, always unplug the power from the power outlet before cleaning.

Mechanical Safety Always keep product's moving path free from obstacles. Before moving the unit up or down, assure at least 20 cm/ 7.9 inch safety distance from any part of the unit to any other elements in order to avoid collision. In case of accident, please stop the operating immediately. Only operate the unit with wheels on plane and stable floors. Move the unit on plane floors only. Risk of tilting when overrunning door sills, uneven floor etc. Severe risk of injury when unit tips over. Always move the product with the display in the lowest position. Do not push the Electric Stand from front or back of lift. Do not move the Electric Stand by pushing on Display. Keep fingers and other body parts away from hazardous moving parts. Exceeding the weight capacity can result in serious personal injury or damage to equipment. It is the installer's responsibility to make sure the total weight including accessories does not exceed the maximum load of 100 kg. Using it with heavier screens may result in instability causing tip over and resulting in death or serious injury! The height adjustable feature will not function properly if the total weight exceeds the given maximum load. The installation, maintenance and un-installation of the product should be operated by trained professional and skilled personnel.

The intended use of the product: The product is intended to be used for the mounting and height adjustment of passive or interactive large format display. The product is intended for in-door usage in classrooms, offices or meeting rooms at

temperature between 0 to 40°C. Please make sure indoor environment is dry and cool. Normal operating humidity is 10%-90%RH. Do not use this product in out-door environment. The product is intended to use by adults; children under the age of 16 should only use the product under adult supervision. Duty cycle : 2 min on/ 18 min off. The Electric Stand motors are intended for intermittent use, continuous or extended use (more than 2 minutes) will cause over heating and safety system will switch the motors off. If motors overheating occurred, please cool down the motors at least 18 minutes before re-operating. The system will automatically switch back to normal when the motors have cooled down. Anti-collision function: When the product encounters obstacles or shakes during descending or ascending operations, the product will automatically stop and move upward 50mm.

Material list

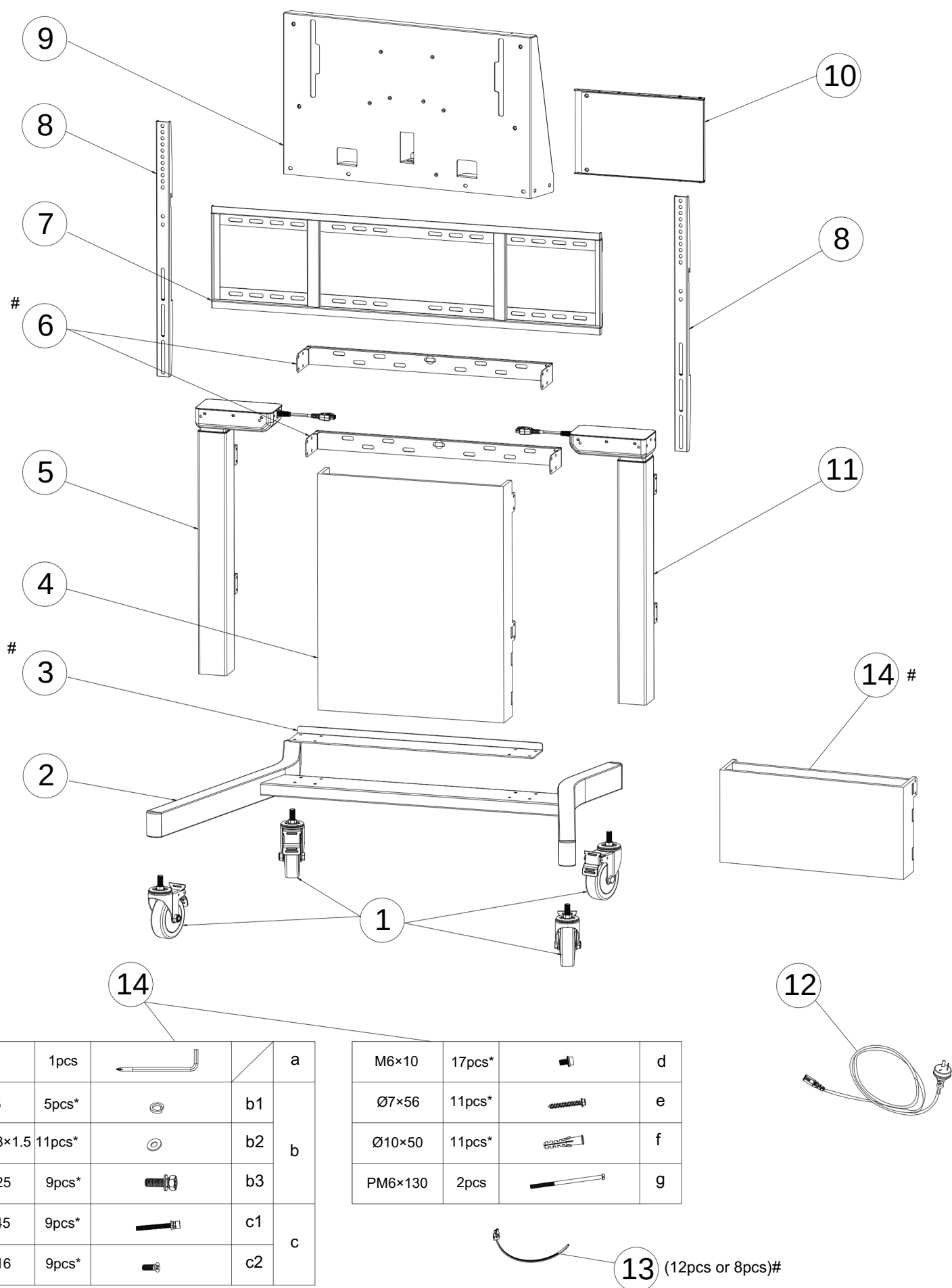

Note: "*" means it contains 1 spare part. "#" indicates that the quantity or type may vary due to different model configurations, please refer to the actual product. This manual follows the installation instructions of Accessory 4. If you choose other configurations, please check the corresponding installation steps during installation.

Mobile Stand Assembly

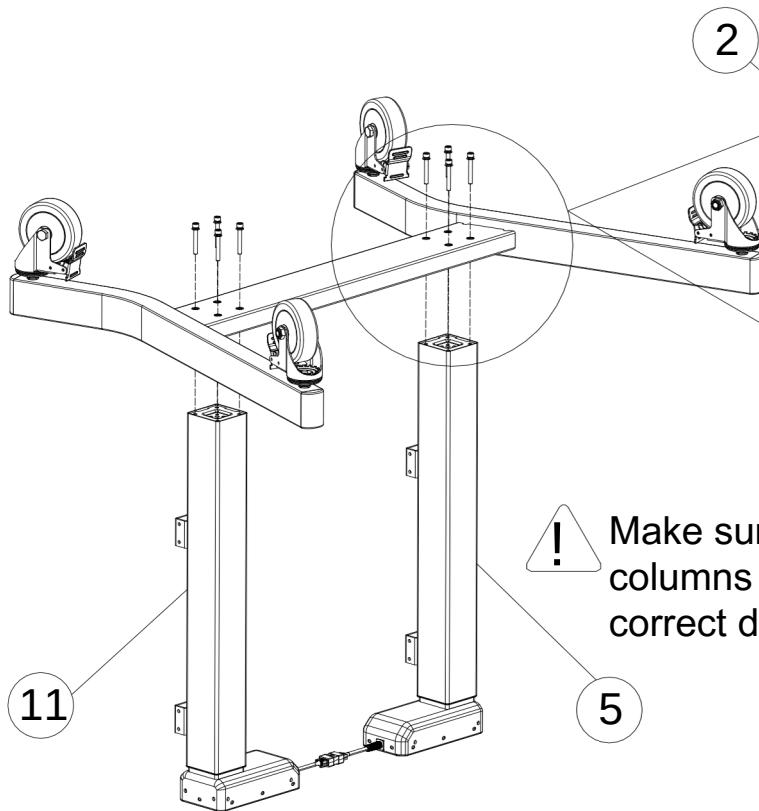
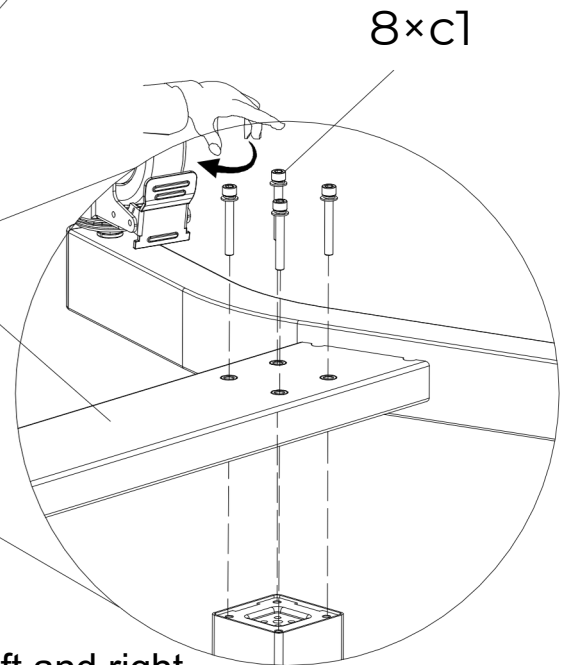
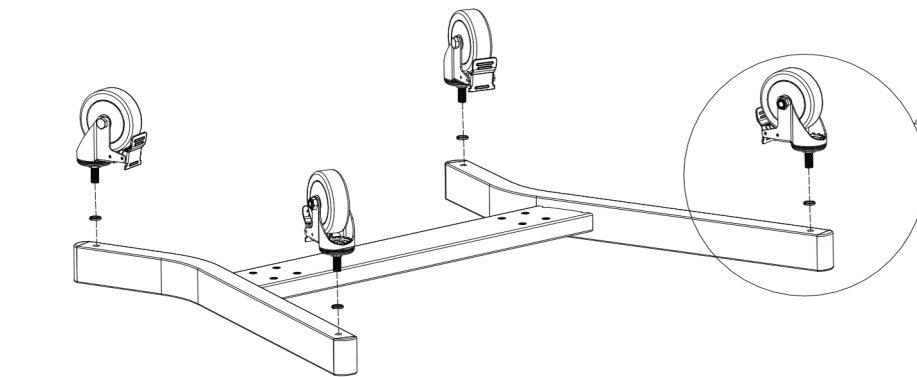
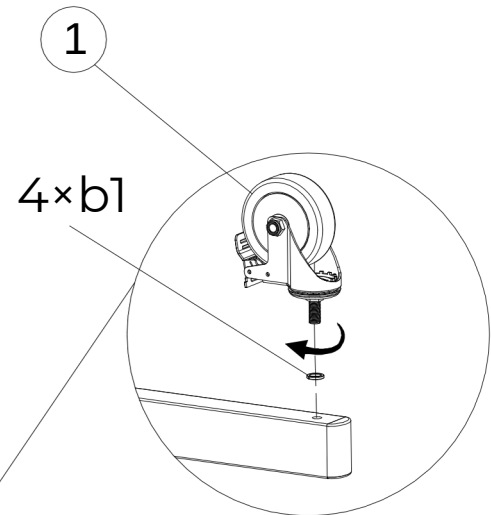
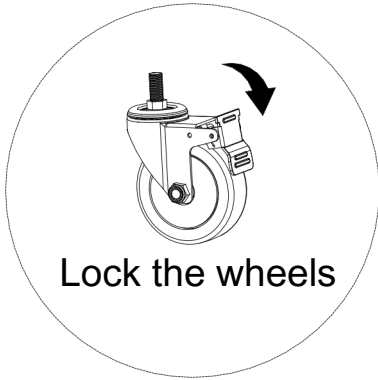

! Make sure the left and right columns are installed in the correct direction.

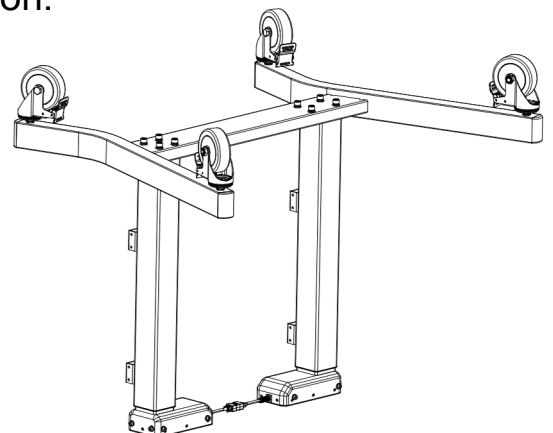

! Carefully place the two lifting columns on a flat non-scratching surface.

Make sure that the motor cable connectors facing inward .

! Turn the tripod upside down and have at least two people working. Do not tighten the screws there.

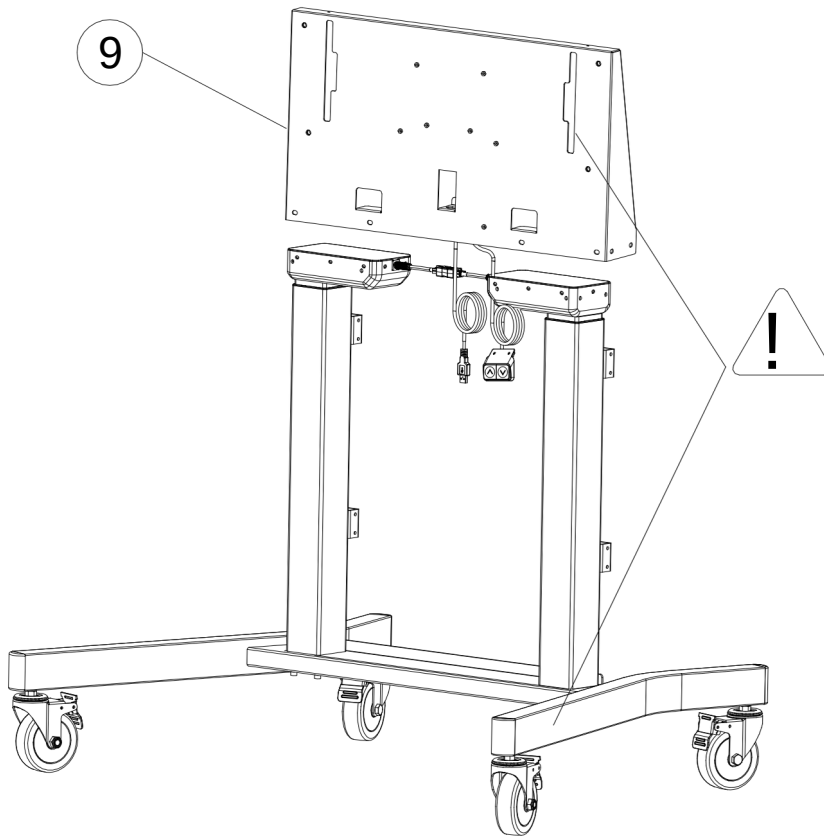

The display mount assembly faces the longer side of the base leg.

I



The screw in partialy,do not tighten yet.

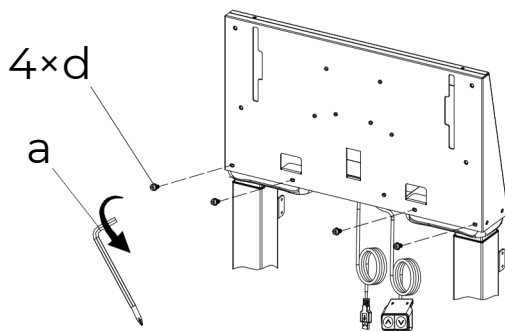

II



The screw in partialy,do not tighten yet.

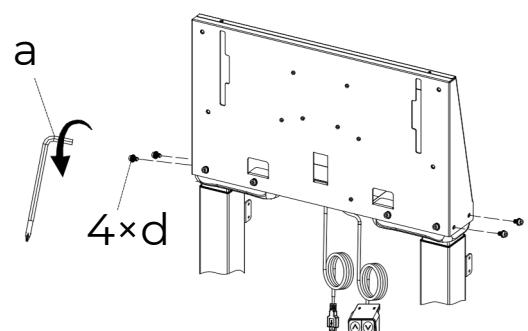

III



Tighten the front screws.

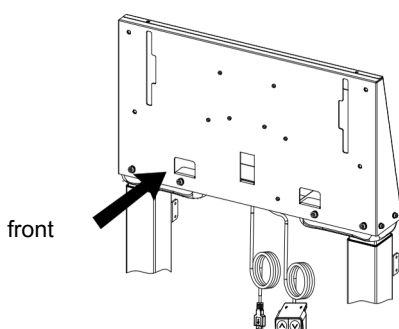

IV



Tighten the screws on the both side.

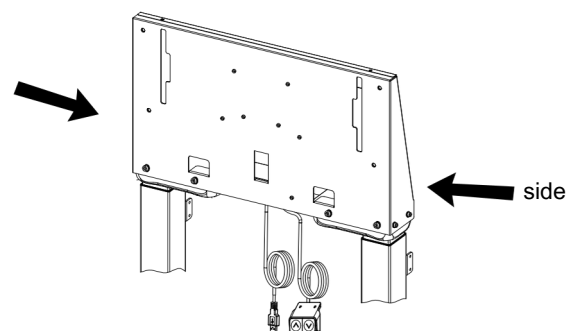

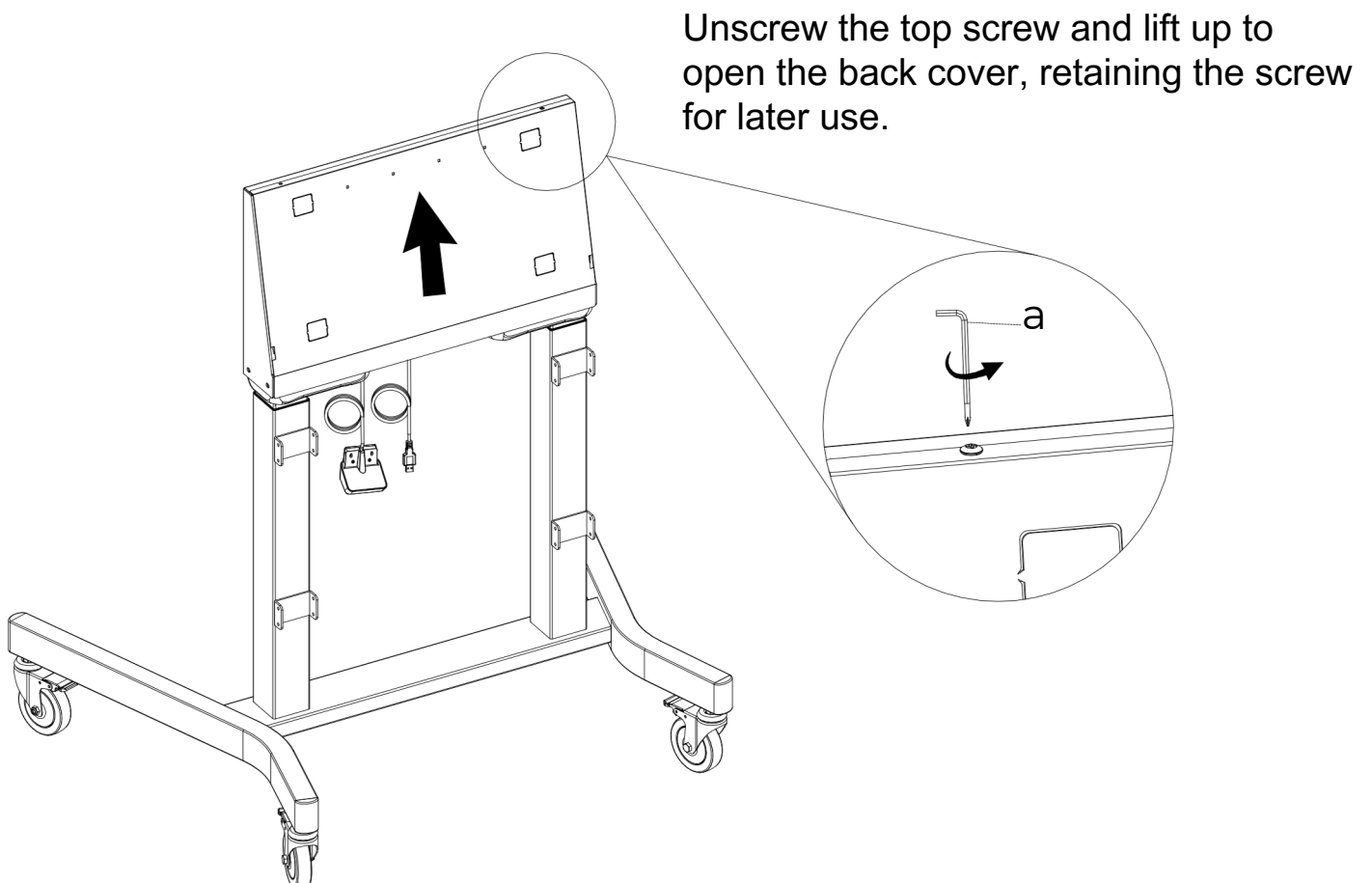
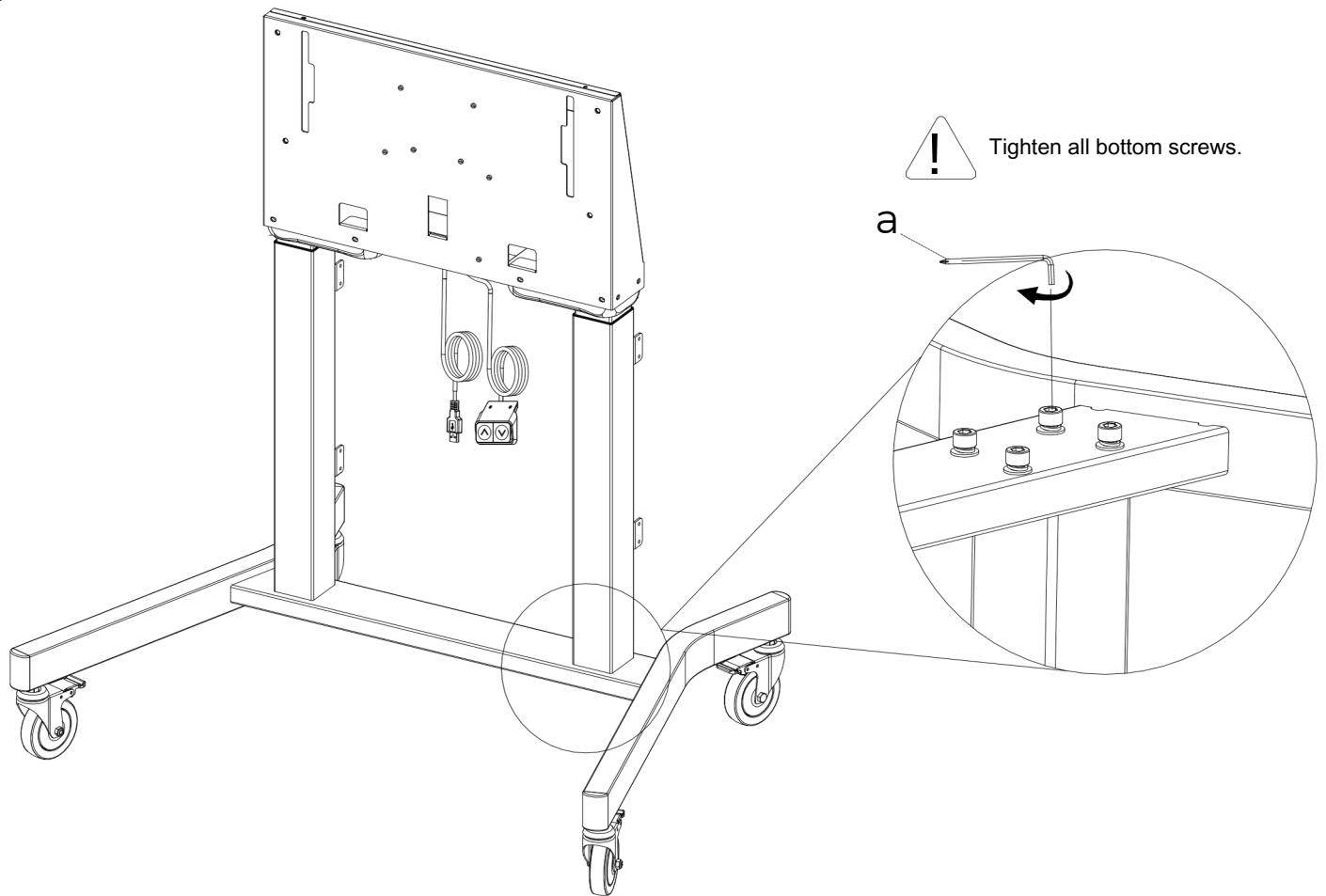

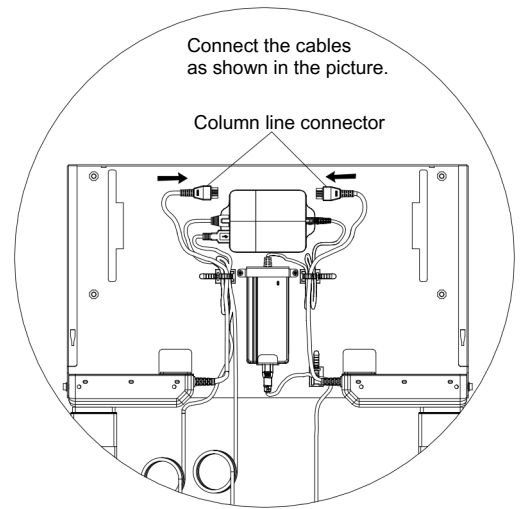
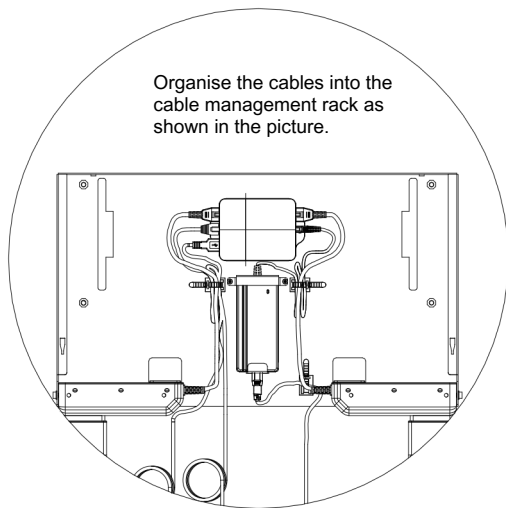

Restore the back cover.

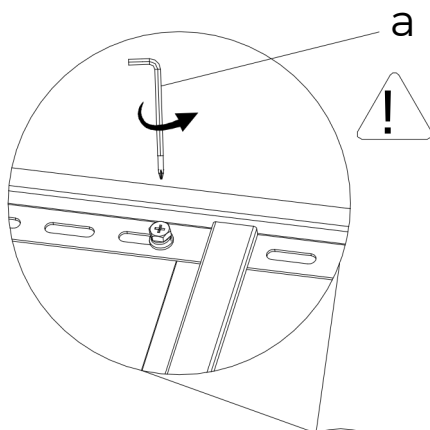
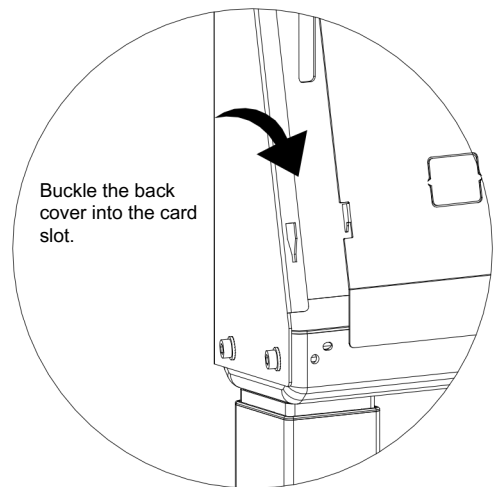
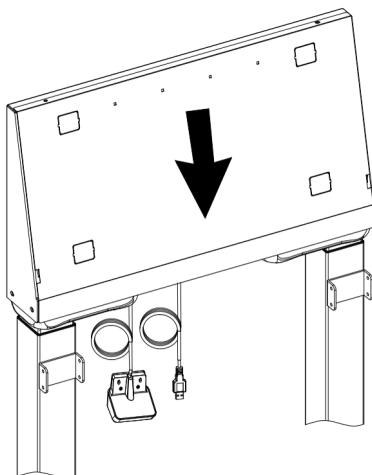

Remove the screws there and keep them for later use.

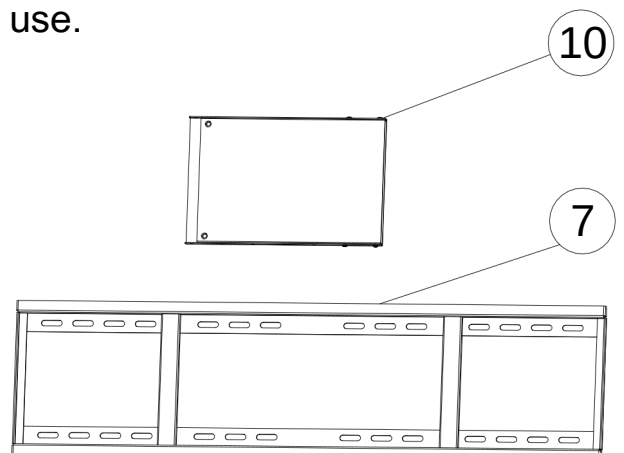
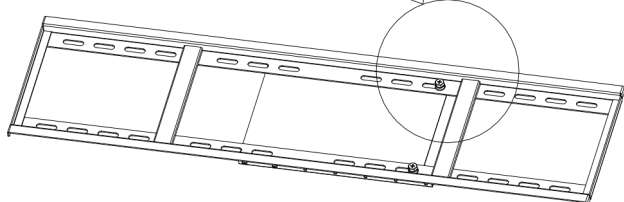



Make sure the screws are tightened.

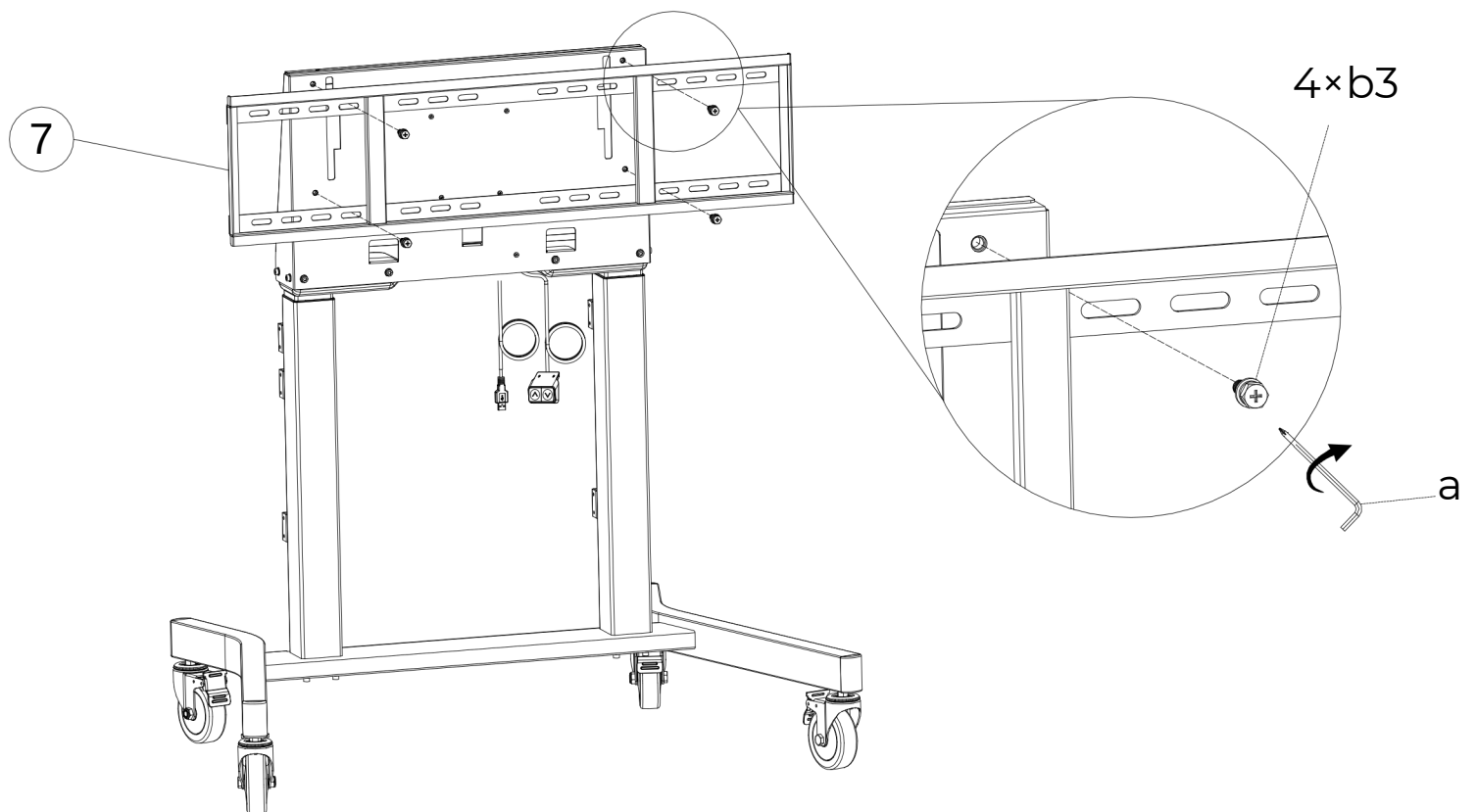

Make sure the screws are tightened.

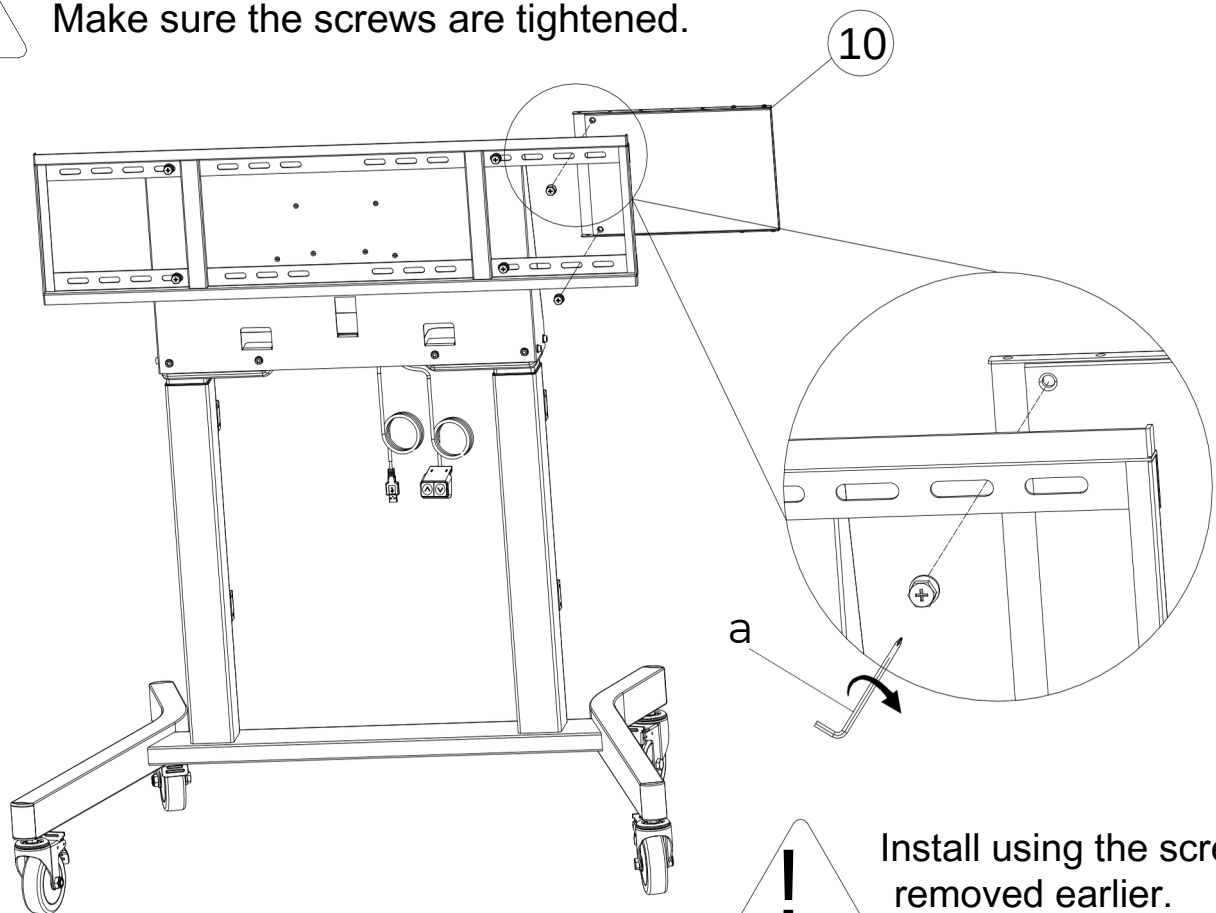

Install using the screws removed earlier.

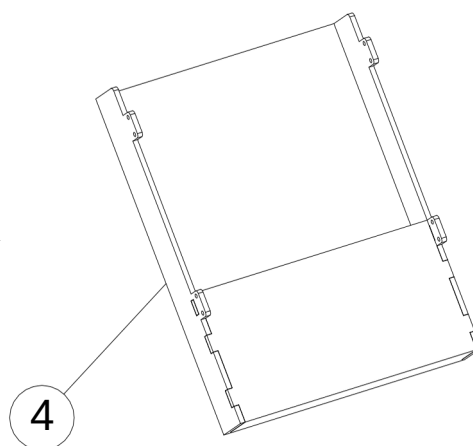
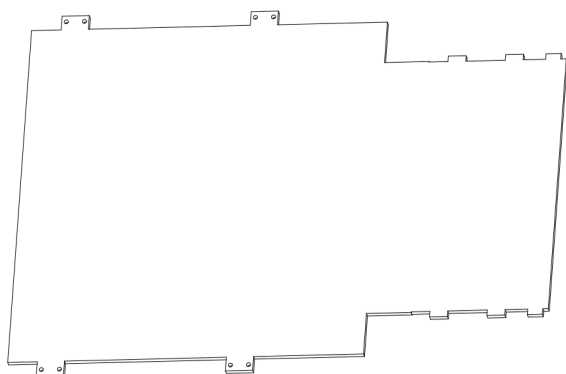

Install the felt box as shown.



Make sure the cable ties are tightened.

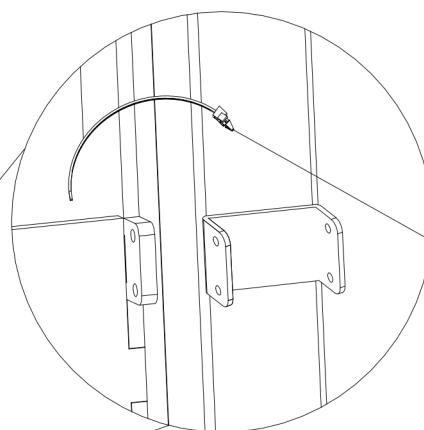
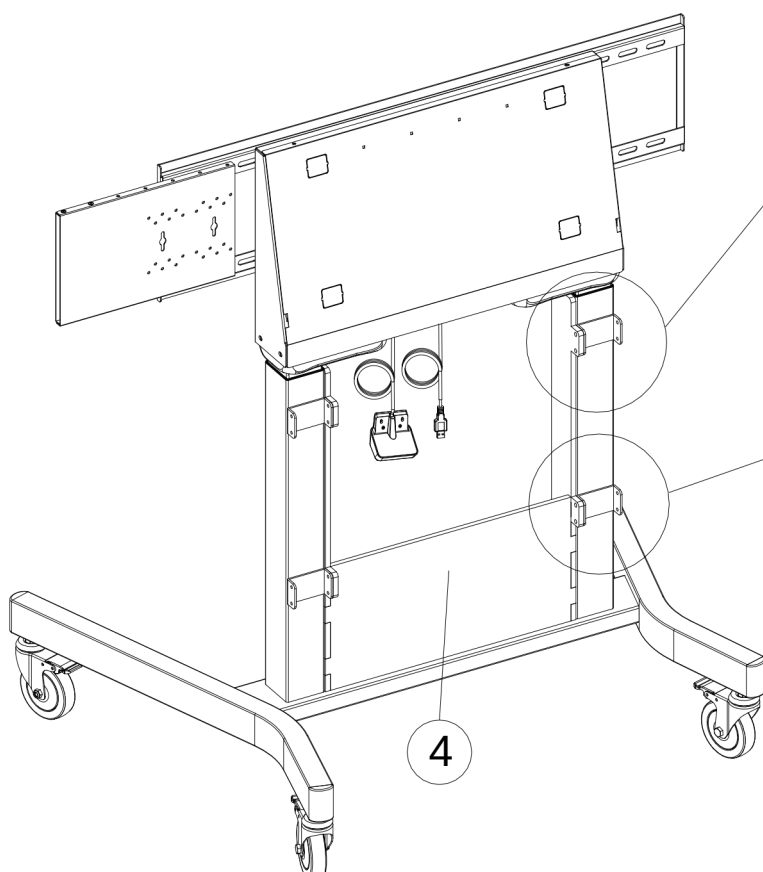

8× 13

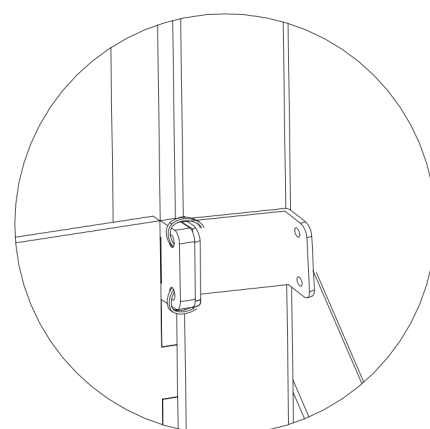



Make sure the screws are tightened.

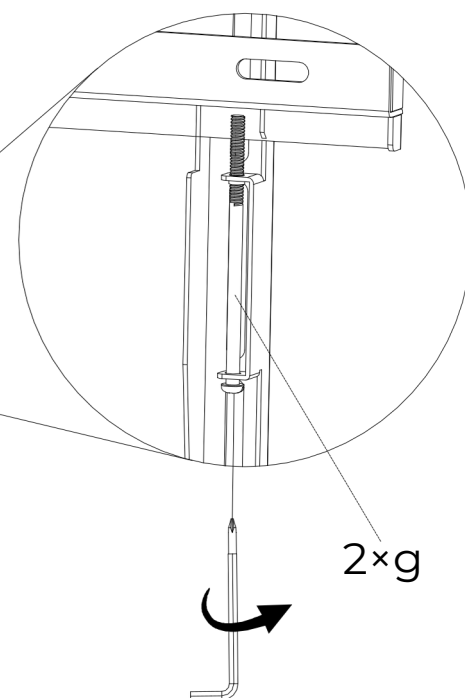
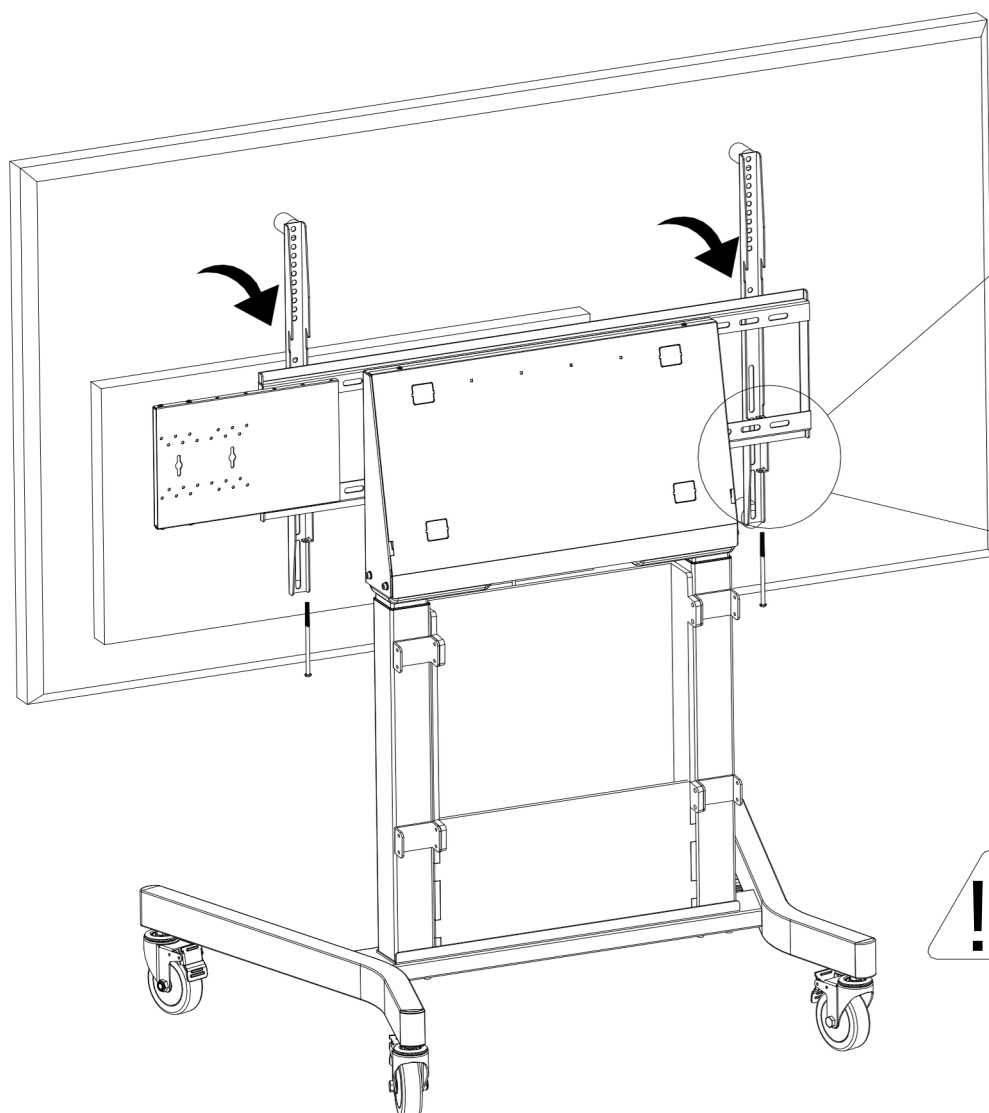
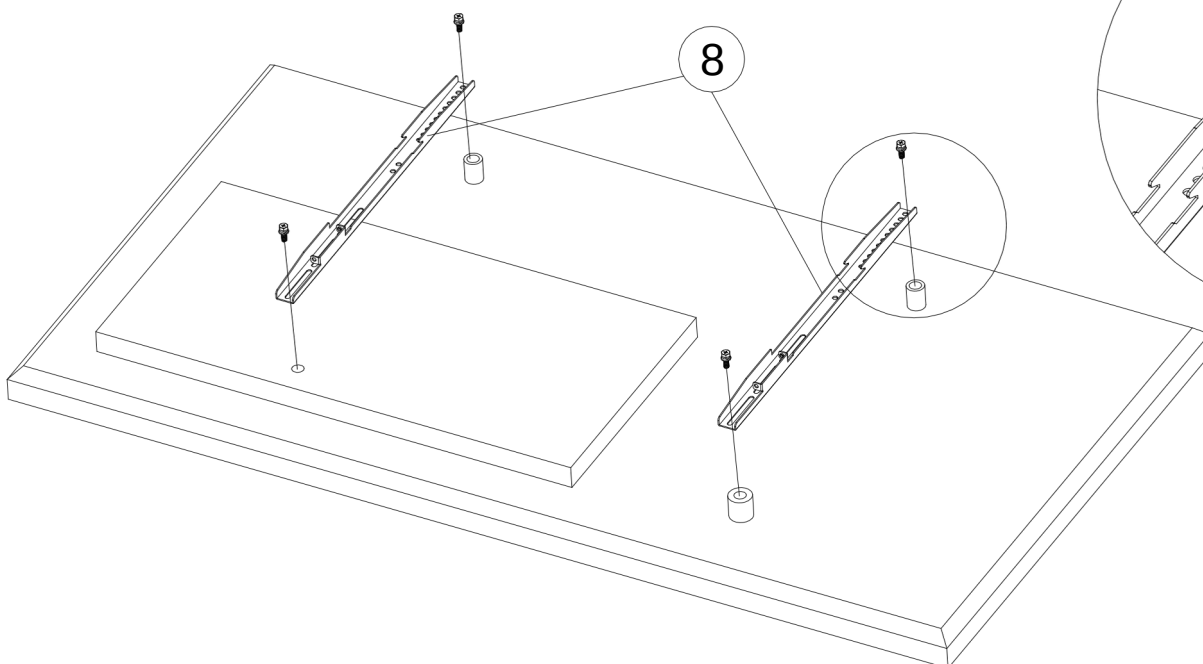
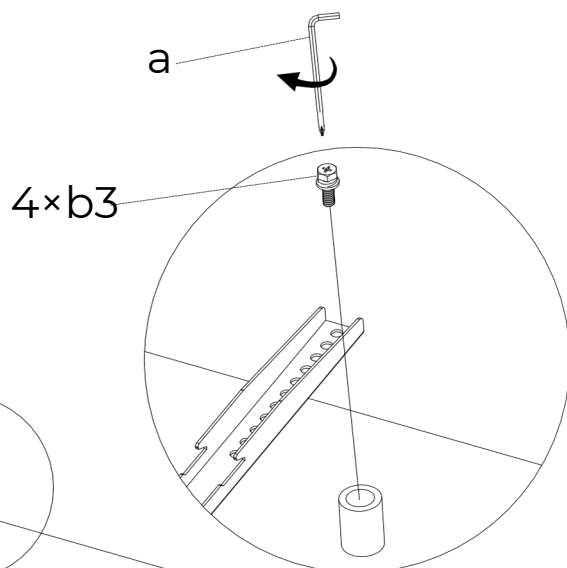

Make sure the safety screws on both sides are tightened.



Remove the protective paper. It is recommended to attach to base of display. Ensure surface is flat and clean.

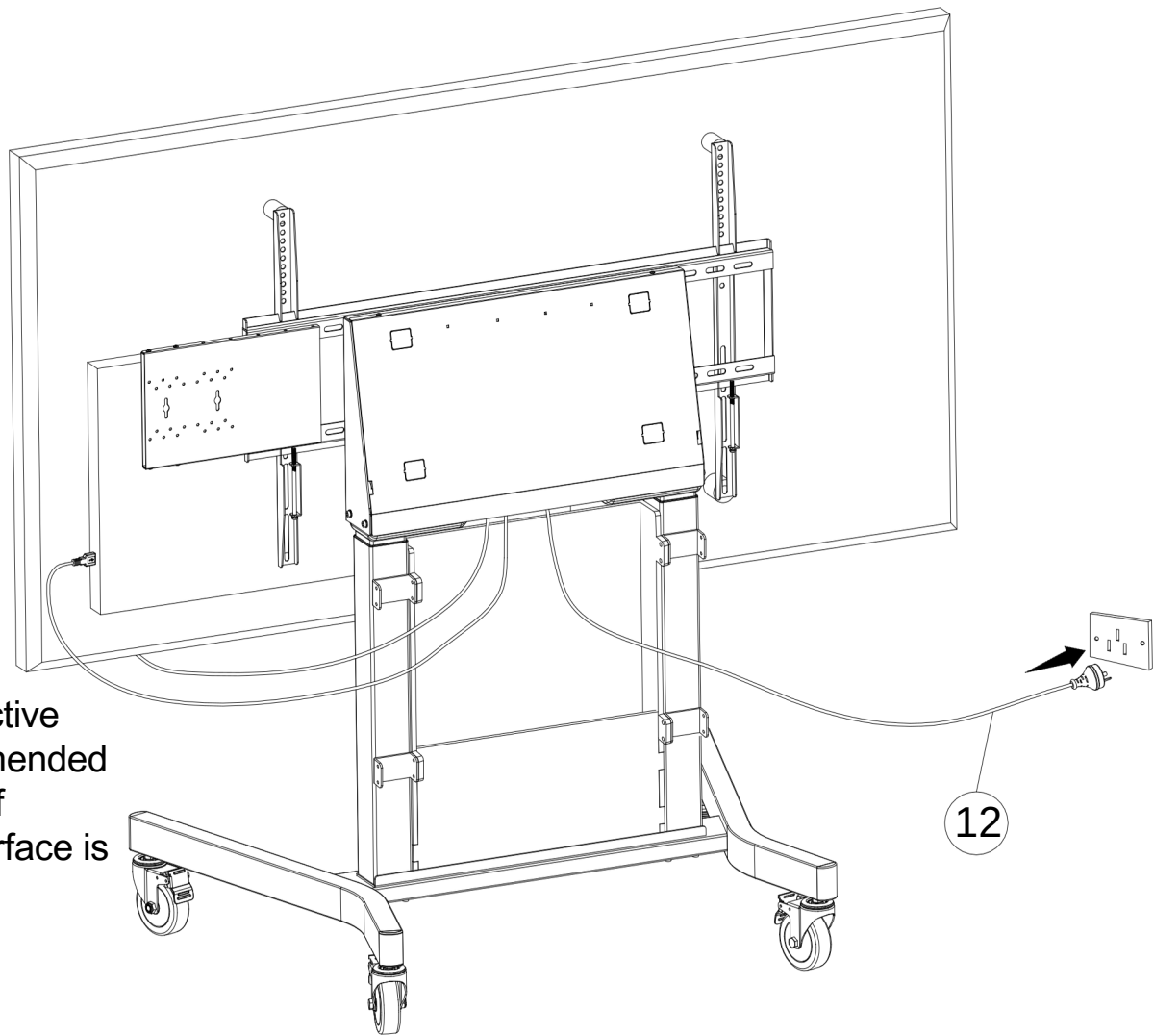

Other scene descriptions.

In some scenarios, you can use the holes at the locations shown in the figure to pass through cables.

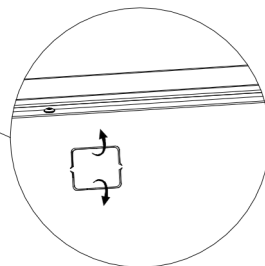
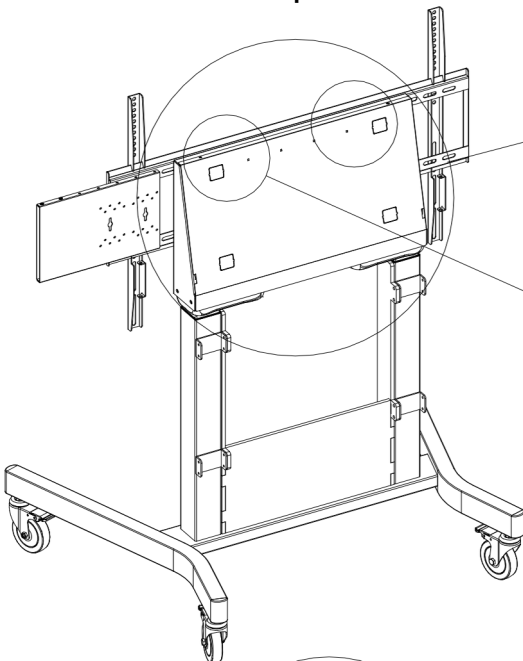

In order to open the square hole smoothly, you need apply up and down pressure several times and first to remove.



This operation cannot be repaired, please use it when needed.

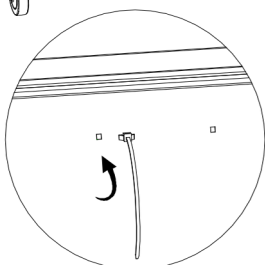

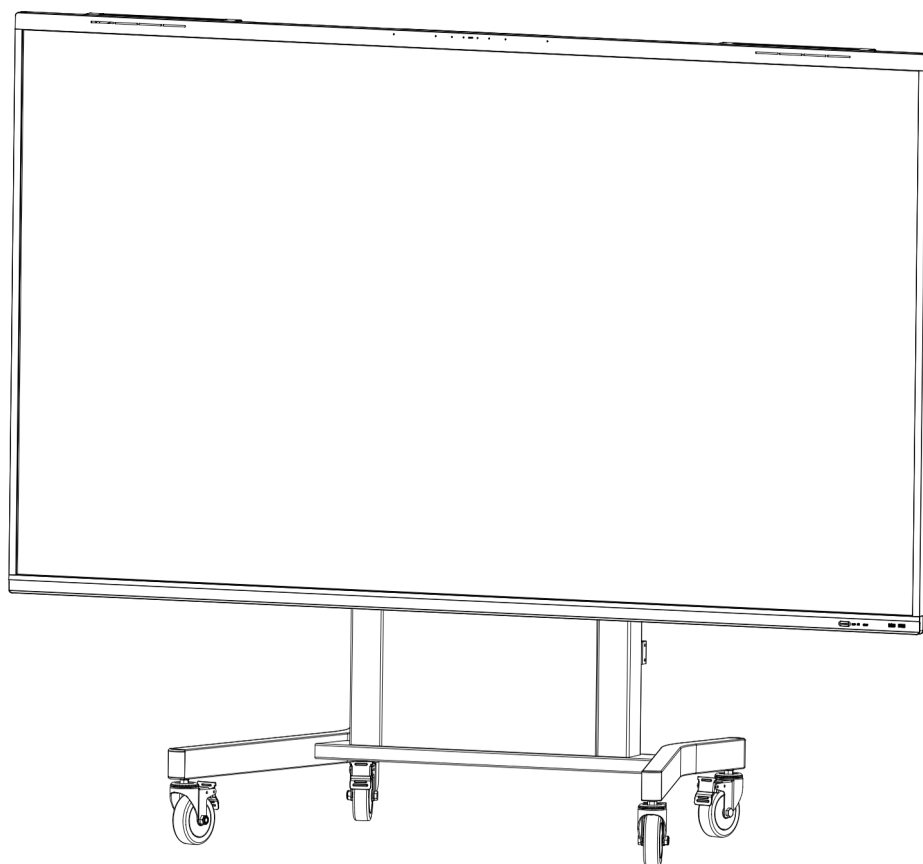

In some usage scenarios, inserting cable ties into the small holes can also help you organise cables.

Function test

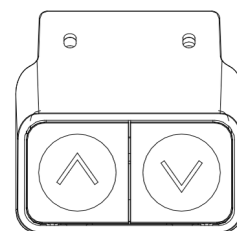

Controller



Pattern	Items	Function description
	Up	Control the rise of the Electric Stand
	Down	Control the fall of the Electric Stand



Reset process:

When using it for the first time, you need to press the down button 5s to reset after the reset starts, the columns automatically drop to the lowest point and then automatically rebounds 7mm, which means reset is complete. If it falls to the bottom and bounces 50mm, it needs to be forced to reset. Press the down button for 10s (after falling to the bottom and rebounding 50mm, keep pressing the down button for 5s to reset, when descending to the bottom and rebound 7mm, the reset is complete).

Use the controller to rise the stand, ensure it functions normally, and observe the length of the AC cable to ensure that it will not be pulled.



IFP Control Mode

Turn on the Intelligent Panel, ensure that the Intelligent Panel is connected with the Electric Stand by USB Cable.

The sidebar of the Intelligent Panel will display the control button of the ElectricStand.



Control Mode

NO.	Pattern	Items	Function description
1		UP	Control the rise of the Electric Stand.
2		Down	Control the fall of the Electric Stand.